



**jt** | JORGENSENTURNER



Earls Court Road, Earls  
Court, London, W8

£1,700



 0
  1
  1
  C



# Earls Court Road, Earls Court, London, W8

£1,700



## Summary Description

**\*\*AVAILABLE NOW \*\*** Jorgensen Turner are pleased to offer this modern self contained studio apartment. This lovely property has a large living space, plenty of storage space and a modern bathroom with walk-in shower. is bright and airy throughout and is perfect for a professional single or couple. Early viewings are highly recommended. EPC Rating C

With easy access to Kensington, Earls Court, Fulham and West Brompton transport systems. Earls Court tubes just minutes away.

## Area Map

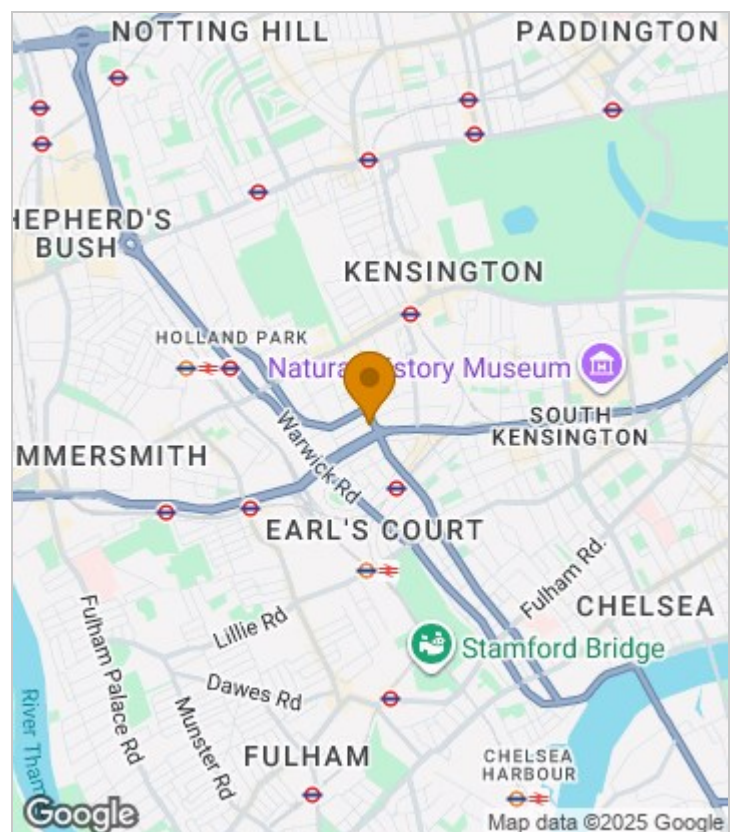





## Floor Plan

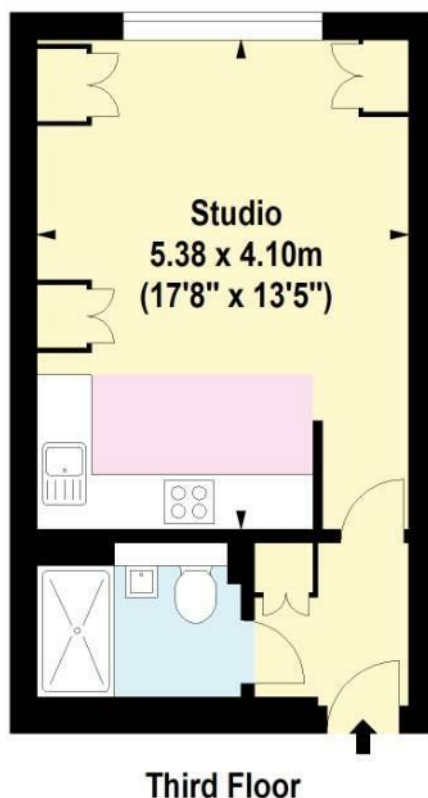

For Identification Purposes Only. Not To Scale. © www.totalvista.uk 2025

Courtleigh, W8

Approx. Gross Internal Area  
29.82 Sq M - 321 Sq Ft

TOTALVISTA

## Energy Efficiency Graph

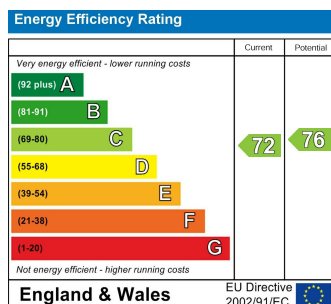

## Viewing

Please contact our Lettings SB Office on 0208 740 8740 if you wish to arrange a viewing appointment for this property or require further information.

- Modern studio
- spacious and well designed
- minutes walk to Earls Court tube station
- lift access
- central location
- Available 1st October
- EPC Rating: C

For further information contact:

Lettings SB, 234 Uxbridge Road, Shepherd's Bush, London, W12 7JD

Tel: 0208 740 8740 Email: [enquiries@jorgensenturner.com](mailto:enquiries@jorgensenturner.com)

<https://www.jorgensenturner.com/>

### Disclaimer

These particulars, whilst believed to be accurate are set out as a general outline only for guidance and do not constitute any part of an offer or contract. Intending purchasers should not rely on them as statements of representation of fact, but must satisfy themselves by inspection or otherwise as to their accuracy. No person in this firm's employment has the authority to make or give any representation or warranty in respect of the property.